

# PHASE 1 STAGE 2 GRADING PLAN

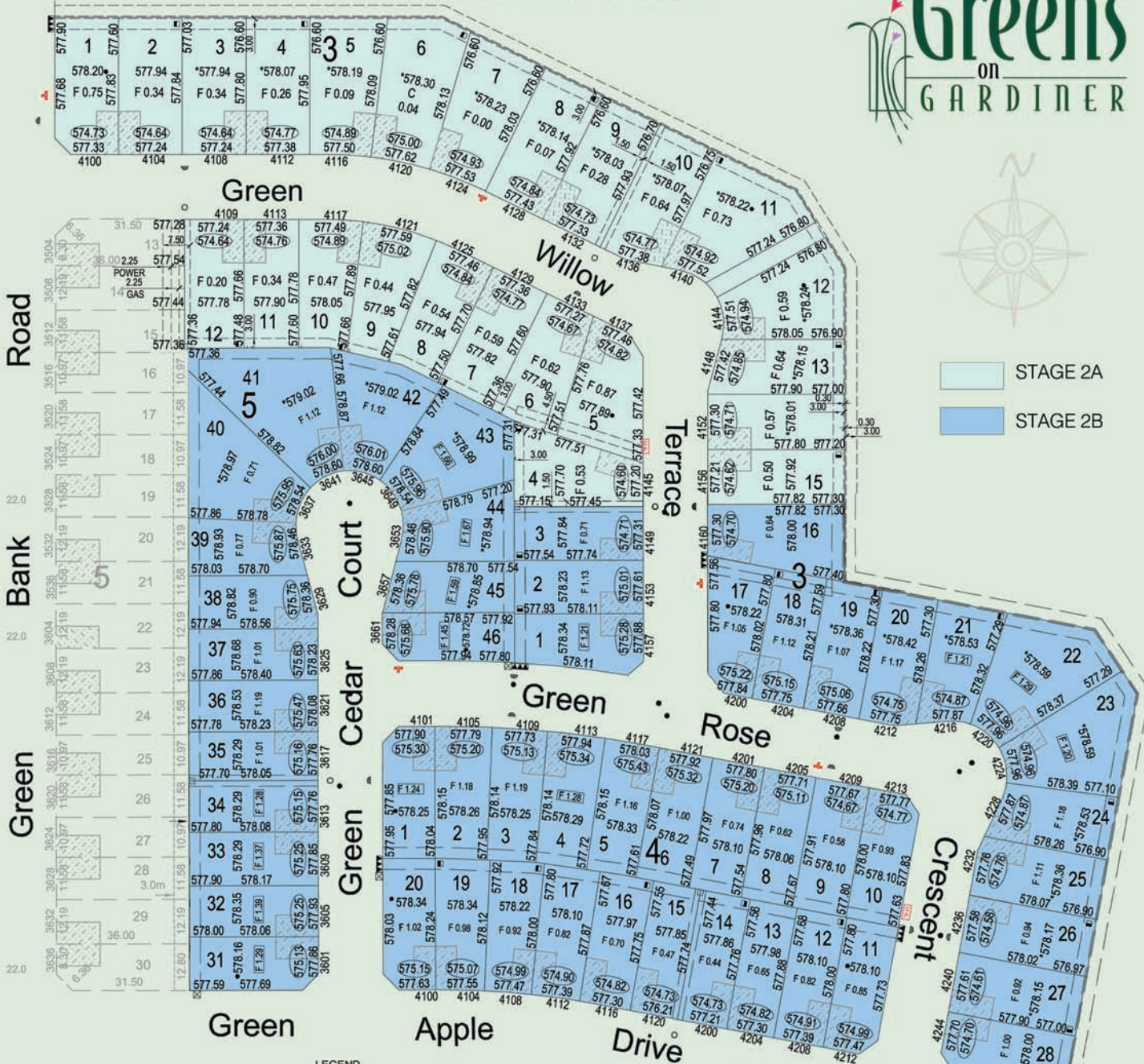

- STAGE 2A
- STAGE 2B

Road  
Bank  
Green

Development  
Managed by

3249 Eastgate Drive  
Regina, Saskatchewan S4Z 1A4  
Tel: 306-789-0891  
Fax: 306-775-2973  
Cell: 306-539-9120  
www.greensongardiner.com

- LEGEND**
- SERVICE INVERT AT THE CURB
  - LOT NUMBER
  - FINISHED SIDE YARD ELEVATION
  - FINISHED GRADE AT LOT CORNERS
  - CIVIC ADDRESS
  - TOP OF CURB ELEVATION AT C/L OF LOT
  - DEPTH OF FILL FROM FINISHED GRADE ELEVATION TO ORIGINAL GROUND ELEVATION AT 15 m SETBACK FILLS - (F) MIN. GROUND ELEVATION CUTS - (C) AVG. GROUND ELEVATION
  - FINISHED GRADE AT CORNERS OF HOUSE AT HOUSE SET BACK
  - ALL HOUSE SETBACKS ARE 6m UNLESS OTHERWISE NOTED
  - FINISHED BUILDING GRADE ELEVATION GREATER THEN 0.31 m ABOVE SIDE YARD. SIDE YARD MUST BE TERRACED, OR A RETAINING WALL MUST BE PLACED BY BUILDER.
  - \* DROP FROM GRADE AT HOUSE TO THE FRONT OR BACK OF THE LOT IS GREATER THAN 1.0 m.
  - \*\* DROP FROM GRADE AT HOUSE TO THE FRONT OR BACK OF THE LOT IS GREATER THAN 2.0 m.
  - \*\*\* DROP FROM GRADE AT HOUSE TO THE FRONT OR BACK OF THE LOT IS GREATER THAN 3.0 m.
  - FILL EXCEEDS 1.2 m FROM THE BUILDING GRADE ELEVATION TO ORIGINAL GROUND AT 15 m SET BACK
  - DRIVEWAY DESIGNATION
  - EASEMENT
  - STREETLIGHT AND POLE
  - POWER POLE
  - 3 PHASE TRANSFORMER
  - POWER PEDESTAL
  - CATCH BASIN
  - SIDE INLET CATCH BASIN
  - CATCH BASIN/MANHOLE
  - HYDRANT
  - CURB BOX
  - CATV
  - 579.45 SPOT ELEVATION
  - MAILBOX



This drawing is provided for information purposes only. Please refer to Grading Plan as prepared by Associated Engineering & approved by the City of Regina

Kind to the environment and your lifestyle